

MALDIVES LAND AND SURVEY AUTHORITY

MINISTRY OF HOUSING AND INFRASTRUCTURE

Office (PABX): +(960) 3004300, Fax: +(960) 3004254

Email: survey@housing.gov.mv

Web: www.surveyofmaldives.gov.mv,

Ameenee Magu, Maafannu, Male', 20392, Maldives



CONTROLPOINT DETAILS	Station Number	PSM 5433
Coordinate Information		
Geodetic	Grid	
WGS 84	UTM Zone 43	
Lat: 6°50'37.0693"N	E:	284715.264
Long: 73°03'06.7201"E	N:	756899.053
Ellp Height:	Orth Height:	1.314
Island Name: HA.DHONAKULHI	Date:	29 June 2015

Monument description & method of survey:

- Monument Type A as in Technical Brief (with a 0.3m X 0.3m X 1.0m Concrete Column)
- Stainless steel plate fixed to concrete by Four bolts
- Horizontal coordinates fixed by GNSS Static survey.
- A level double level run was recorded as PSM5434 as the base, vertical control level of PSM5433 was determined from the level circuit
- PSM 5433 is 100mm below ground Level

General site condition & access:

- Easily accessible area with wide angle of sky visibility
- Located in the vegetation line
- PSM Established on Eastern side of Island, located near the water sports center

Owner: Dhonakulhi Investments Pvt. Ltd



Bottom



North Height 1.6m / Distance 2m



East Height 1.6m / Distance 2m

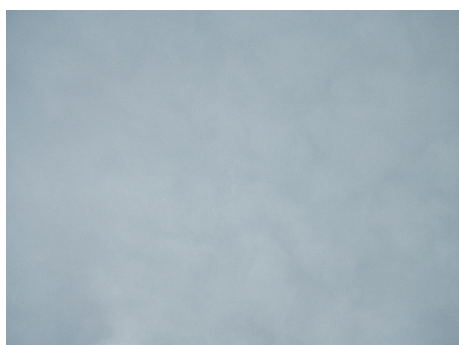

Up Height 1.6m



South Height 1.6m / Distance 2m



West Height 1.6m / Distance 2m

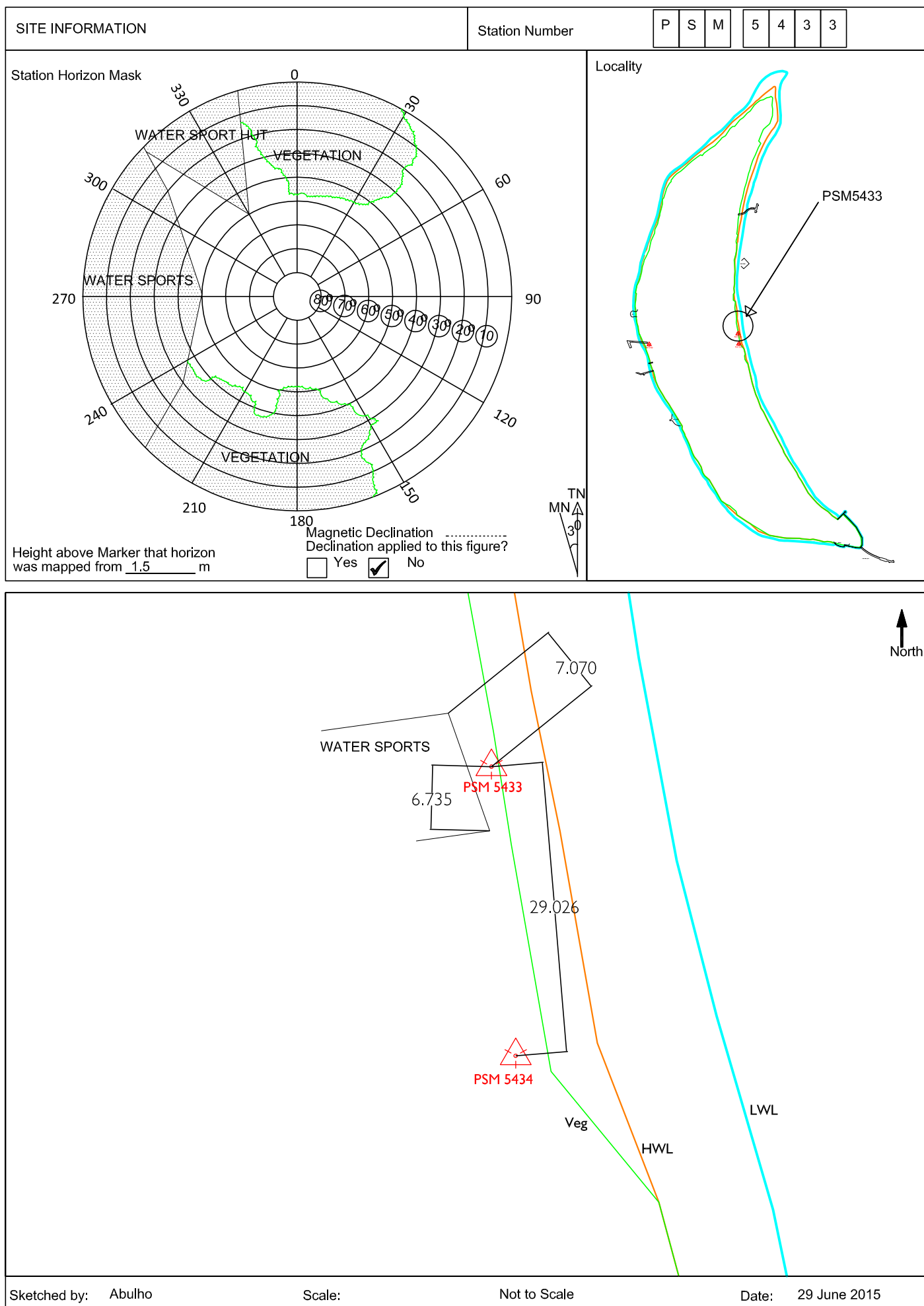

MALDIVES LAND AND SURVEY AUTHORITY

MINISTRY OF HOUSING AND INFRASTRUCTURE
Office (PABX): +(960) 3004300, Fax: +(960) 3004254
Email: survey@housing.gov.mv
Web: www.surveyofmaldives.gov.mv,
Ameenee Magu, Maafannu, Male', 20392, Maldives



CONTROLPOINT DETAILS	Station Number	PSM 5434
Coordinate Information		
Geodetic	Grid	
WGS 84	UTM Zone 43	
Lat: 6°50'36.1282"N	E:	284717.681
Long: 73°03'06.8026"E	N:	756870.128
Ellp Height:	Orth Height:	1.228
Island Name: HA.DHONAKULHI	Date:	29 June 2015

Monument description & method of survey:

- Monument Type A as in Technical Brief (with a 0.3m X 0.3m X 1.0m Concrete Column)
- Stainless steel plate fixed to concrete by Four bolts
- Horizontal coordinates fixed by GNSS Static survey.
- Elevation reduced relative to Local MSL by double level run
- PSM 5434 is 150mm below ground Level

General site condition & access:

- Easily accessible area with wide angle of sky visibility
- Located in the vegetation line
- PSM Established on Eastern side of Island

Owner: Dhonakulhi Investments Pvt. Ltd



Bottom



North Height 1.6m / Distance 2m



East Height 1.6m / Distance 2m



Up Height 1.6m



South Height 1.6m / Distance 2m



West Height 1.6m / Distance 2m

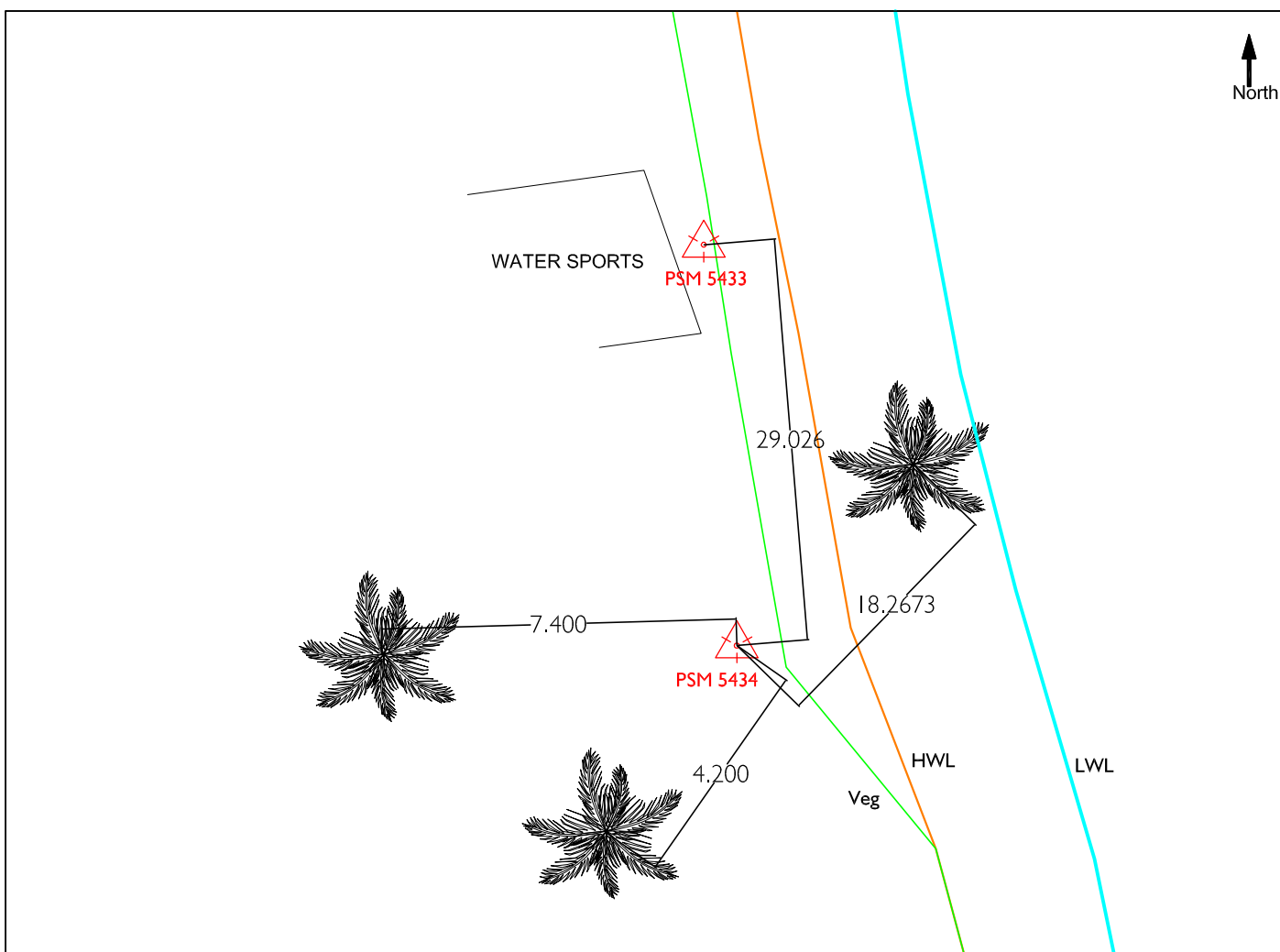
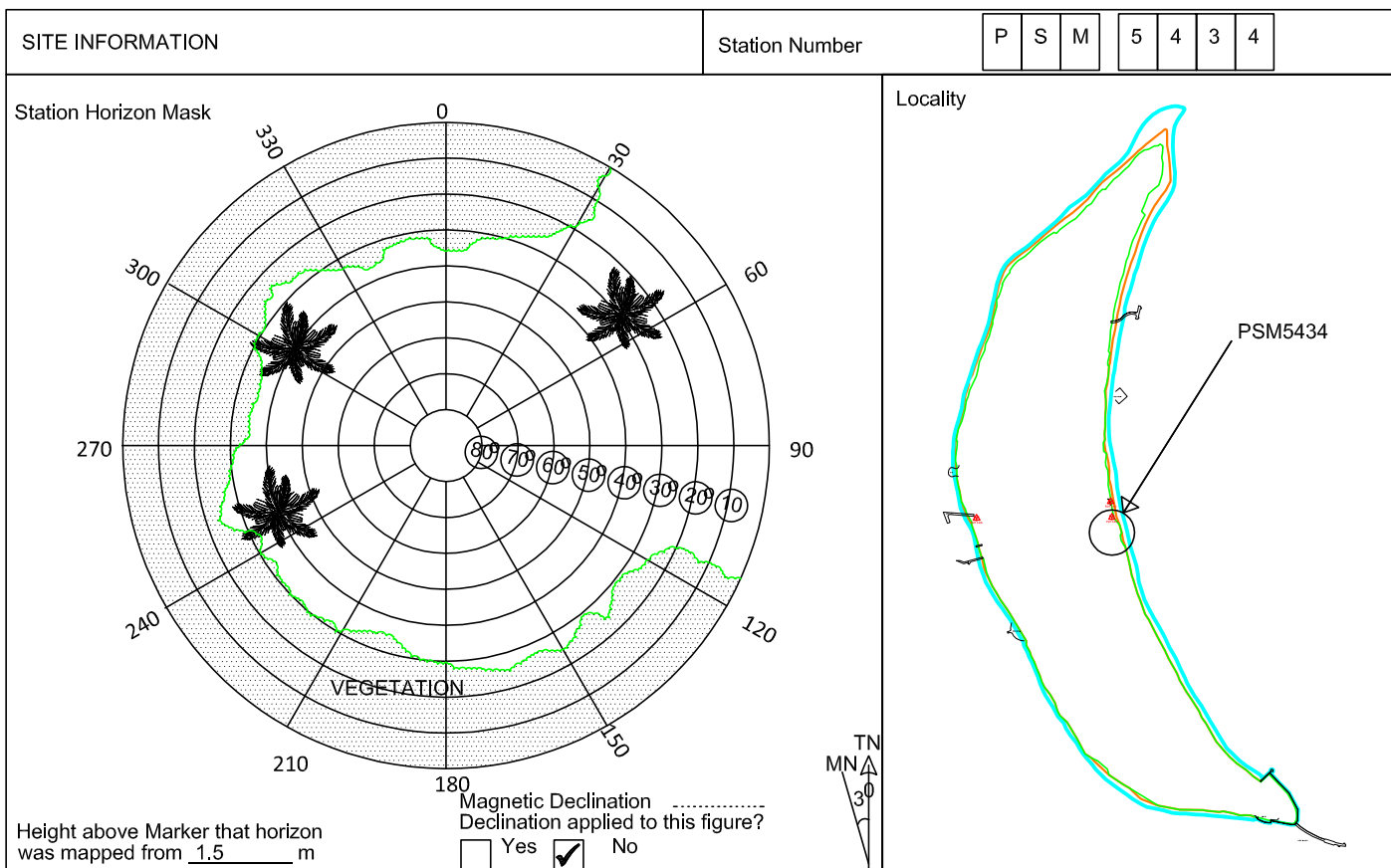

Sketched by: Abulho Scale: Not to Scale Date: 29 June 2015

MALDIVES LAND AND SURVEY AUTHORITY

MINISTRY OF HOUSING AND INFRASTRUCTURE
Office (PABX): +(960) 3004300, Fax: +(960) 3004254
Email: survey@housing.gov.mv
Web: www.surveyofmaldives.gov.mv,
Ameenee Magu, Maafannu, Male', 20392, Maldives



CONTROLPOINT DETAILS	Station Number	PSM 5435
Coordinate Information		
Geodetic	Grid	
WGS 84	UTM Zone 43	
Lat: 6°50'36.0378"N	E:	284463.210
Long: 73°02'58.5163"E	N:	756868.380
Ellp Height:	Orth Height:	0.665
Island Name: HA.DHONAKULHI	Date:	29 June 2015

Monument description & method of survey:

- Monument Type A as in Technical Brief (with a 0.3m X 0.3m X 1.0m Concrete Column)
- Stainless steel plate fixed to concrete by Four bolts
- Horizontal coordinates fixed by GNSS Static survey.
- A level double level run was recorded as PSM5434 as the base, vertical control level of PSM5435 was determined from the level circuit
- PSM 5435 is 100mm below ground Level

General site condition & access:

- Easily accessible area with wide angle of sky visibility
- Located in the vegetation line
- PSM Established on Western side of Island, located near the supply jetty

Owner: Dhonakulhi Investments Pvt. Ltd



Bottom



North Height 1.6m / Distance 2m



East Height 1.6m / Distance 2m



Up Height 1.6m



South Height 1.6m / Distance 2m



West Height 1.6m / Distance 2m

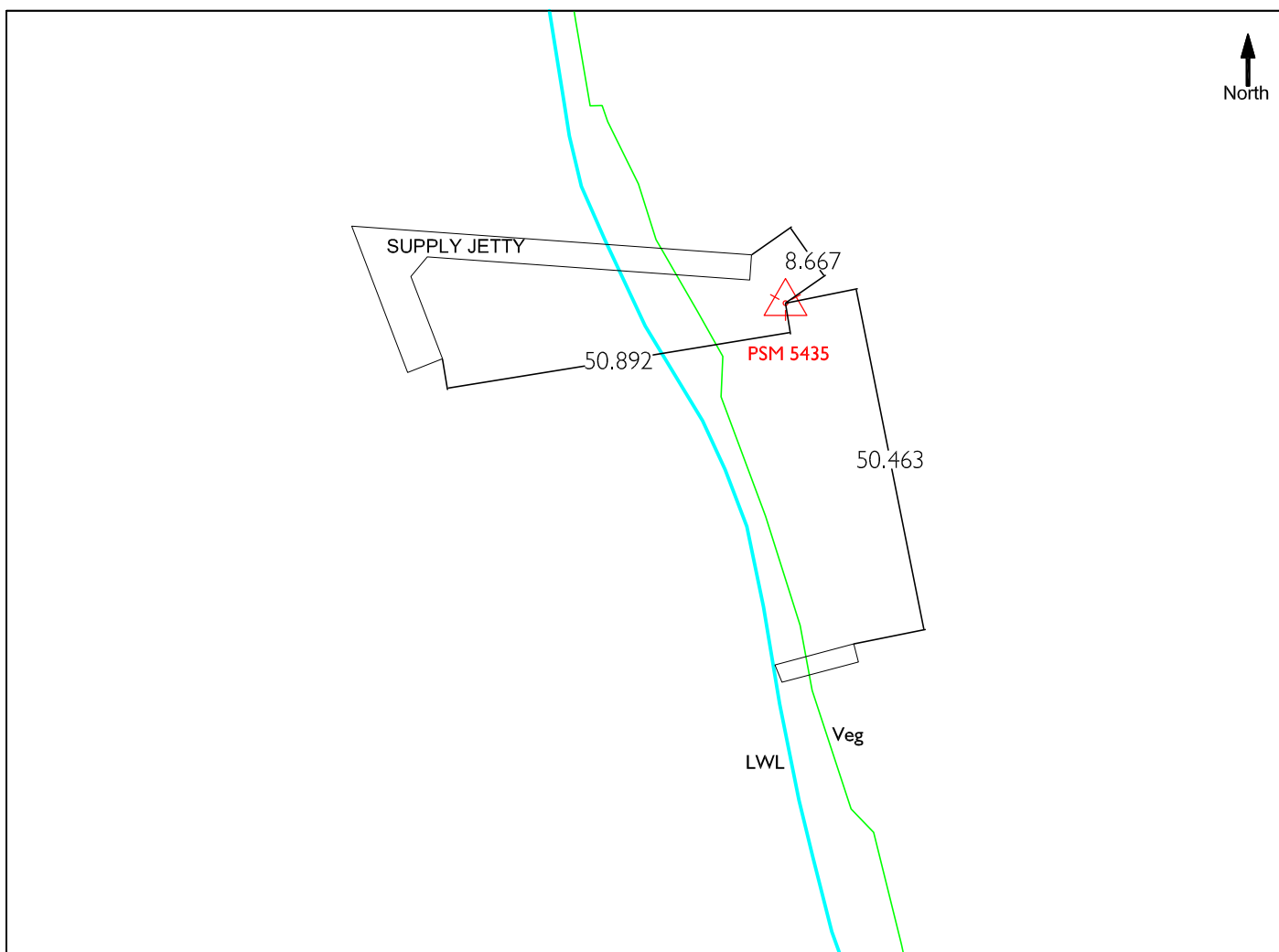
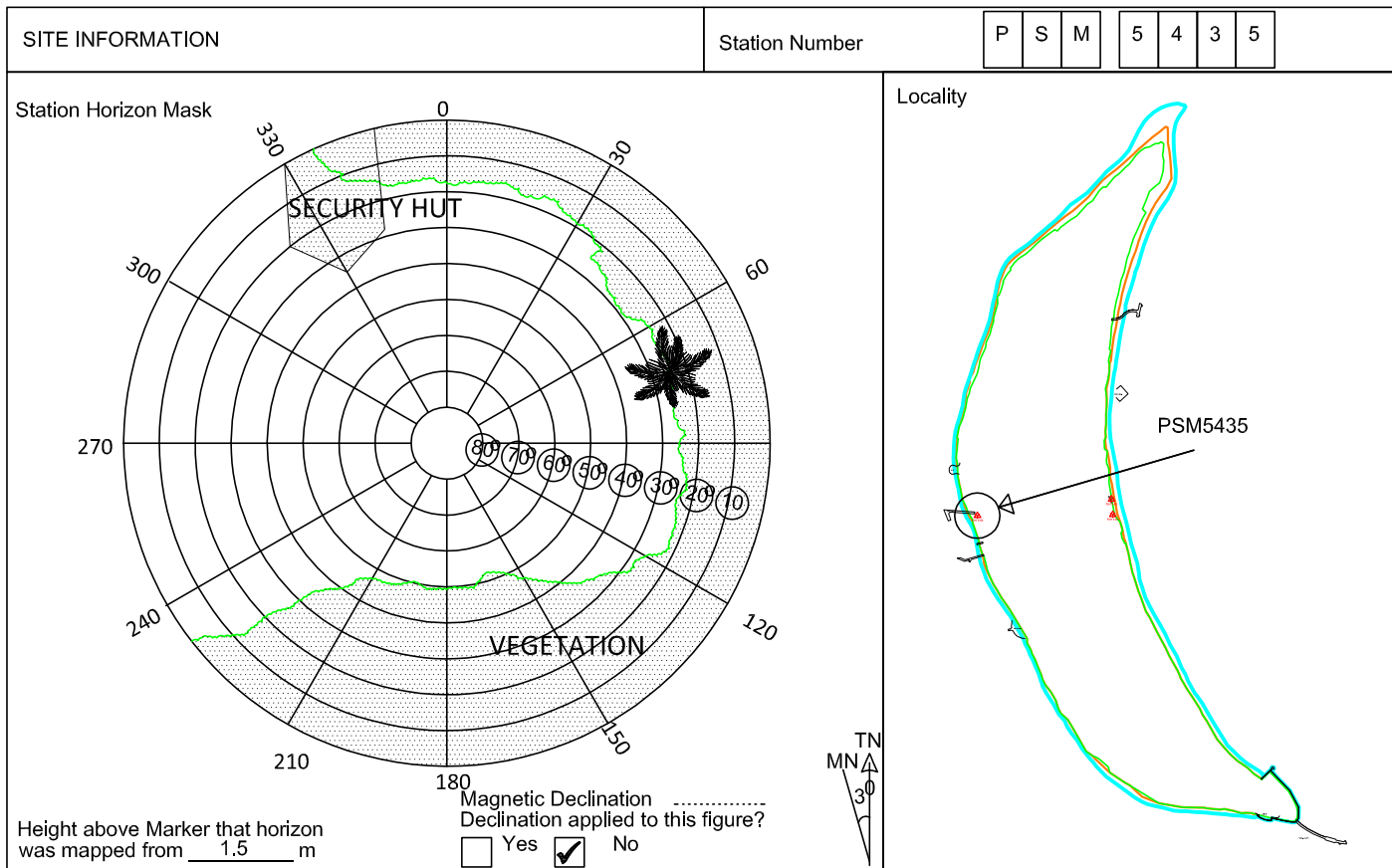

Sketched by: Abulho Scale: Date: 29 June 2015